

| REVISION | | | |
|----------|-------------|------|----------|
| Rev. | Description | Date | Approval |
| - | - | - | - |

Assembly Drawing

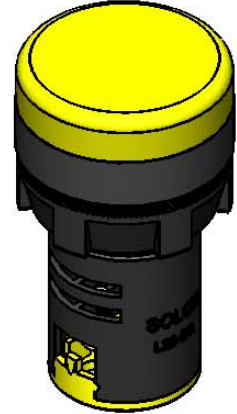

Panel cutoff

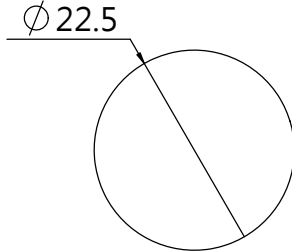
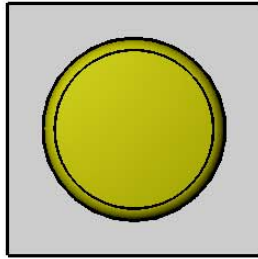
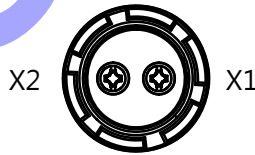
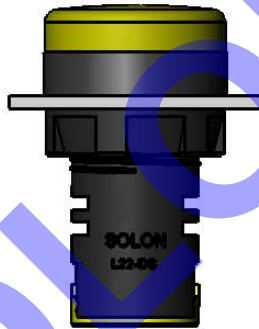
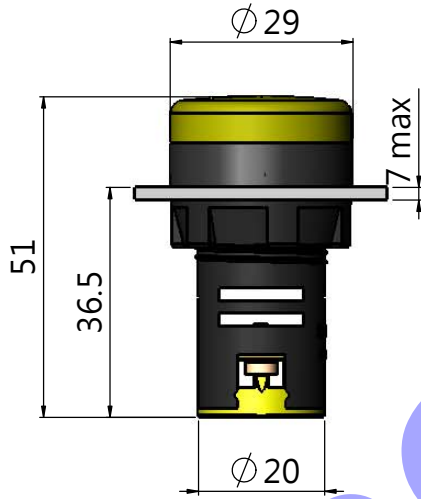

Notes:

1. Materials: Body- PBT resin, UL94-V0
Lens- PC resin, UL94-V0
2. Protection Level: IP-40 (IEC 529)
3. Ambient temperature: -20°C up to +70°C
4. Net weight: 250 g

Indicator schematics

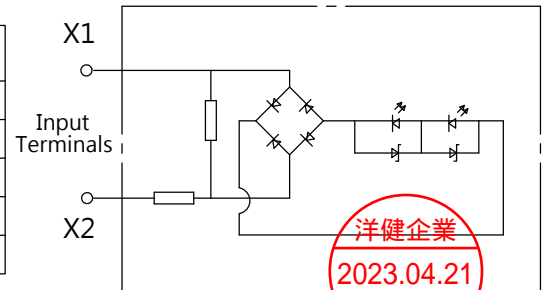

| Part number | Input voltage | Rated current | Color temperature | View angle | Lumens |
|-------------|-----------------|---------------|-------------------|------------|--------|
| L22-DS220Y | 220-230 V ac/dc | 4 mA | 585-595 nm | 120° | 0.6 lm |
| L22-DS110Y | 110-120 V ac/dc | 6 mA | 585-595 nm | 120° | 0.7 lm |
| L22-DS24Y | 24-28 V ac/dc | 24 mA | 585-595 nm | 120° | 3.0 lm |
| L22-DS12Y | 12-24 V ac/dc | 24 mA | 585-595 nm | 120° | 3.0 lm |
| L22-DS6Y | 6-7 V ac/dc | 24 mA | 585-595 nm | 120° | 3.0 lm |



| | | | | | | | |
|-----------|---------|------------------------------|--|----------------------|-------|---|--|
| | | DIMENSIONS ARE IN MILLIMETER | | NAME | DATE | Model NO. L22-DSY | |
| | | TOLERANCES: | | DRAWN | Neafa | 2013/6/21 | |
| | | FRACTIONAL ± | | CHECKED | | | Card NO. L22-003 |
| | | ANGULAR: MACH ± BEND ± | | ENG APPR. | | | PART NO. AA-9703-0 |
| | | TWO PLACE DECIMAL ± | | MFG APPR. | | | PART NAME Indicator (Yellow) 指示燈 (黃) |
| | | THREE PLACE DECIMAL ± | | Q.A. | | | |
| | | MATERIAL | | SOLON | | SIZE A DWG. NO. AA-9703-0 | |
| | | FINISH | | | | SCALE:1:5 WEIGHT: SHEET 1 OF 1 | |
| NEXT ASSY | USED ON | APPLICATION | | DO NOT SCALE DRAWING | | REV. 0 | |

PROPRIETARY AND CONFIDENTIAL
THE INFORMATION CONTAINED IN THIS DRAWING IS THE SOLE PROPERTY OF SOLON ENTERPRISE CO., LTD. ANY REPRODUCTION IN PART OR AS A WHOLE WITHOUT THE WRITTEN PERMISSION OF SOLON ENTERPRISE CO., LTD. IS PROHIBITED.